

The logo for Melvyn Danes Estate Agents is located in the top right corner. It consists of a yellow oval with a green border. Inside the oval, the word "melvyn" is written in a small, green, sans-serif font. Below it, the word "Danes" is written in a large, bold, green, sans-serif font. Underneath "Danes", the words "ESTATE AGENTS" are written in a smaller, green, sans-serif font.

melvyn  
**Danes**  
ESTATE AGENTS

A photograph of a two-story brick house with a red tiled roof and a brick chimney. The house has white-framed windows and a white front door with a glass panel. A paved driveway leads to the front of the house. To the right, another house with white walls and a black door is visible. The sky is blue with some clouds.

Ollerton Road  
Yardley  
£350,000

## Description

A well presented and thoughtfully extended semi detached property situated on an extremely popular and conveniently located road in Yardley. This lovely property is a great family home and must be viewed to appreciate the condition and space it has to offer.

Near to a good range of shops, schools and facilities and comprising: enclosed porch, entrance hall, lounge, extended open plan re fitted kitchen diner and side passage to the ground floor. On the upper floors there are three double bedrooms, study, bathroom and en-suite shower room.

Further benefiting from central heating, double glazing, driveway and good size rear garden.



**Accommodation**

**Front Driveway**

**Enclosed Porch**

9'9 x 1'4 (2.97m x 0.41m)

**Entrance Hall**

6'1 x 15'6 (1.85m x 4.72m)

**Enlarged Lounge**

12' x 18'1 into bay (3.66m x 5.51m into bay)

**Extended Open Plan Kitchen Diner**

18'7 x 19'10 (5.66m x 6.05m)

**Side Passage**

3'1 x 24'1 (0.94m x 7.34m)

**Landing**

**Bedroom Two**

12'1 max x 12'5 (3.68m max x 3.78m)

**Bedroom Three**

12'1 x 11'4 (3.68m x 3.45m)

**Study**

7'3 x 9'3 (2.21m x 2.82m)

**Four Piece Bathroom**

7'4 max x 10'11 (2.24m max x 3.33m )

**Landing**

**Master Bedroom**

12'6 x 10'4 to wardrobes (3.81m x 3.15m to wardrobes)

**En-Suite Shower Room**

5'6 x 5'5 (1.68m x 1.65m)

**Rear Garden**



TENURE: We are advised that the property is Freehold.

BROADBAND: We understand that the standard broadband download speed at the property is around 12 Mbps, however please note that results will vary depending on the time a speed test is carried out. The estimated fastest download speed currently achievable for the property postcode area is around 1800 Mbps. Data taken from checker.ofcom.org.uk on 03/07/2026. Actual service availability at the property or speeds received may be different.

MOBILE: Please refer to checker.ofcom.org.uk for mobile coverage at the property. This can vary depending on the network provider and other factors that can affect the local mobile reception and actual services available may be different depending on the particular circumstances, precise location and network outages.

VIEWING: By appointment only with the office on the number below.

These particulars are for general guidance only and are based on information supplied and approved by the seller. Complete accuracy cannot be guaranteed and may be subject to errors and/or omissions. They do not constitute representations of fact or form part of any offer or contract. Any Prospective Purchaser should obtain verification of all legal and factual matters and information from their Solicitor, Licensed Conveyancer or Surveyors as appropriate. The agent has not sought to verify the legal title of the property and the buyers must obtain verification from their solicitor. Photographs are provided for illustrative purposes only and the items shown in these are not necessarily included in the sale, unless specifically stated. The agent has not tested any apparatus, equipment, fixtures, fittings or services mentioned and do not by these Particulars or otherwise verify or warrant that they are in working order.

MONEY LAUNDERING REGULATIONS: Under anti-money laundering legislation, we are obliged to confirm the identity of individuals and companies and the beneficial owners of organisations and trusts before accepting new instructions, and to review this from time to time. To avoid the need to request detailed identity information from vendors and intending purchasers, we may use approved external services which review publicly available information on companies and individuals. However, should those checks, for any reason, fail adequately to confirm identity, we may write to you to ask for identification evidence. If you do not provide satisfactory evidence or information within a reasonable time, we may have to stop acting for you and we would ask for your co-operation in order that there will be no delay in agreeing a sale. Any purchaser who has a provisional offer accepted via this company will be liable to pay a purchase administration fee of £25 inclusive of VAT to cover these checks.

REFERRAL FEES: We may refer you to recommended providers of ancillary services such as Conveyancing, Financial Services and Surveying. We may receive a commission payment fee or other benefit (known as a referral fee) for recommending their services. You are not under any obligation to use the services of the recommended provider.

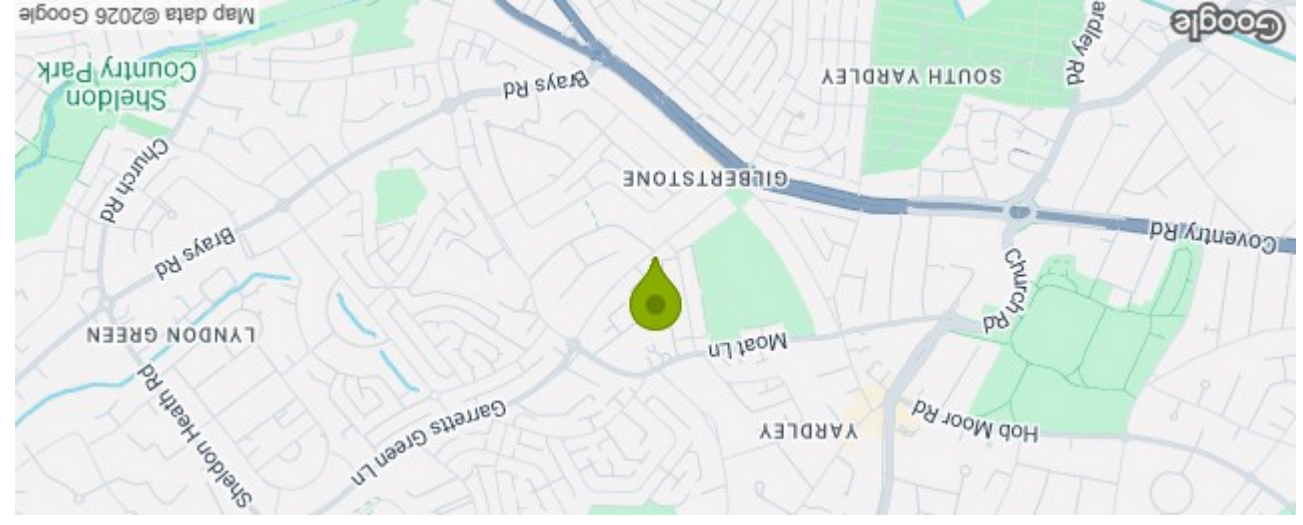

Total area: approx. 138.1 sq. metres (1486.4 sq. feet)

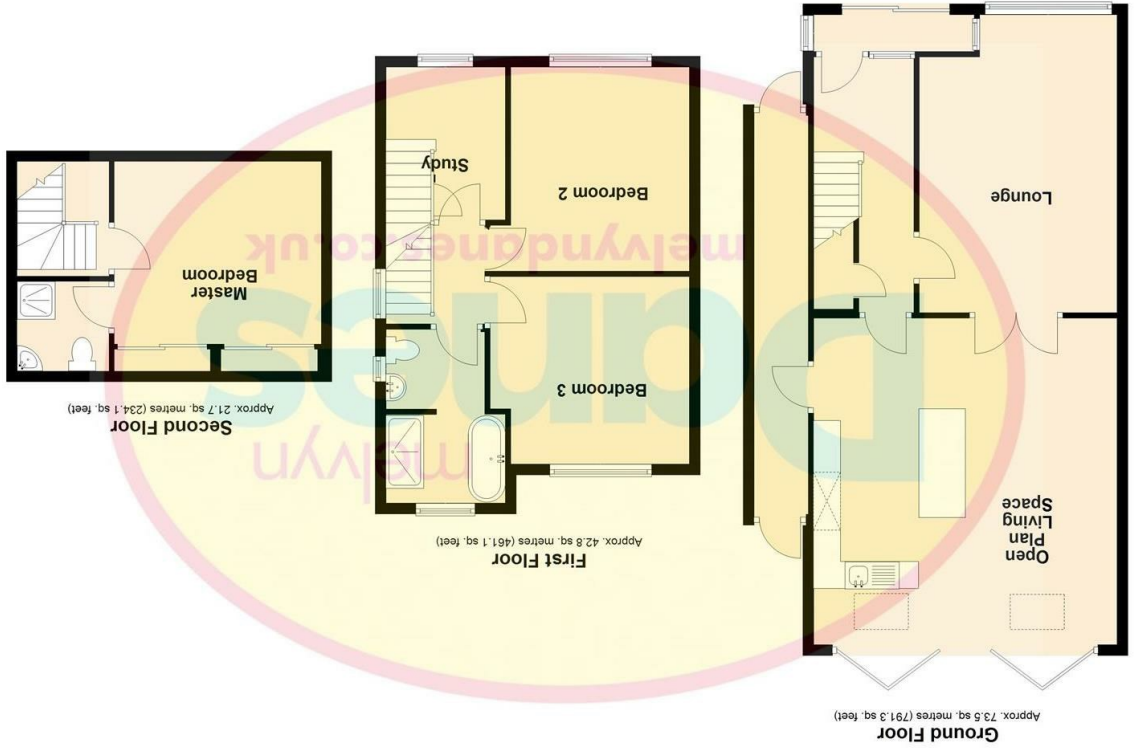

### 2a Ollerton Road Yardley Birmingham B26 1PN Council Tax Band: C

Energy Efficiency Rating	
Very energy efficient - lower running costs	(92 plus) A
(81-91) B	
(69-80) C	
(55-68) D	
(39-54) E	
(21-38) F	
(1-20) G	
Not energy efficient - higher running costs	
Current	69
Potential	80

EU Directive 2002/91/EC

England & Wales

Please note that all measurements and floor plans are approximate and quoted for general guidance only and whilst every attempt has been made to ensure accuracy, they must not be relied on and do not form part of any contract.